

# SealBloc™



**Modular skirt** / Reinforced modular skirt  
for transfer points and longitudinal skirt

**100% COMPATIBLE WITH**  
SUPER-SCREW® / ISC™ / FIX'N GO®

# WHY CHOOSE THE SEALBLOC™ ?

The innovative skirt that offers a perfect seal

**+** The modular skirt with simple, quick and sustainable maintenance

Skirt composed of bracing plate to be joined with anti abrasion rubber modules 200 mm by 5 (1000) or 6 (1200).

Compensation for wear with a simple hammer adjustment.

Only the totally used blocks are quickly replaced for a lower cost.

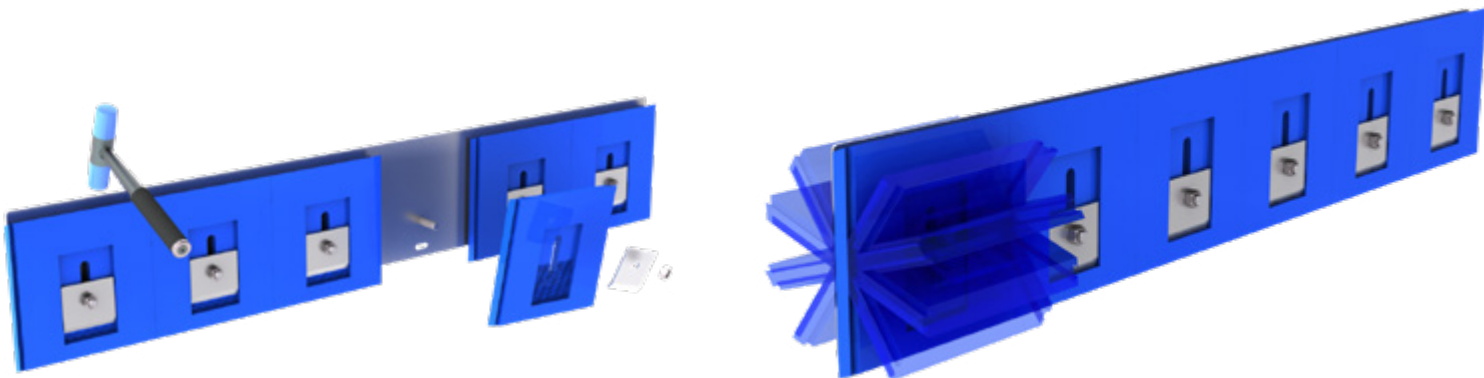
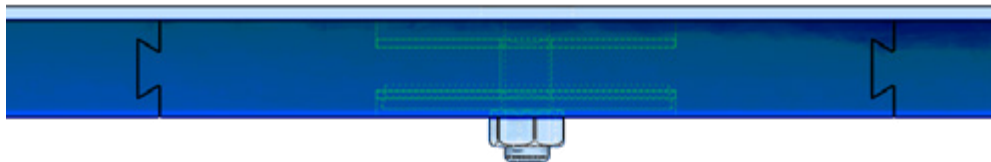
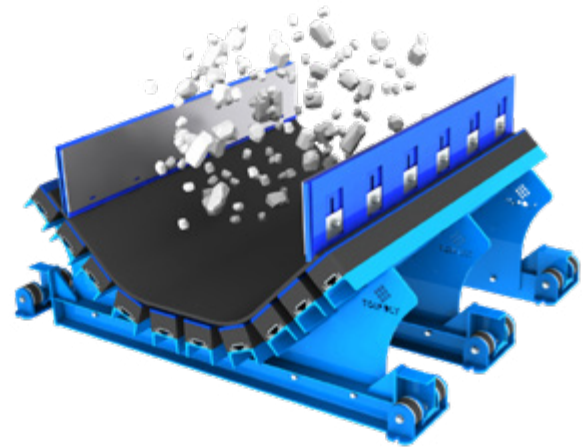

## ADVANTAGES

- Great robustness
- Optimum resistance to abrasion
- Significant improvement of sealing
- Fast replacement of worn blocks
- Very easy installation and adjustment
- Sealing between blocks insured thank to the dove tail profile

## OPTIONS, ACCESSORIES AND VERSIONS

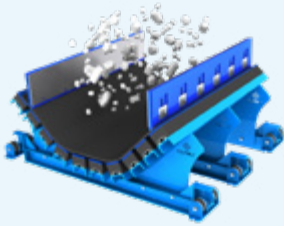

Combines use with **Atlas™** cradle at transfer points allows a perfect sealing.

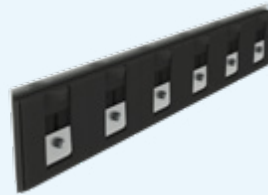

Also available in rubber, non reversible version.

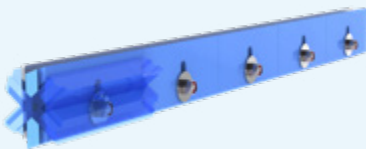

Also available in reversible mini H100 version.

## General information for the SealBloc™

<b>Possible dimensions :</b>	Length 600,1000 to 1200 mm
<b>Surface treatment :</b>	Galvanized steel support
<b>Temperature :</b>	-10° / + 50° C
<b>Scale of pH :</b>	4 to 10 for rubber 3 to 11 for polyurethane
<b>Maximum speed :</b>	7 m/s
<b>Do not expose to :</b>	Projecting staple out of the belt Oils, grease or hydrocarbide for rubber Hot water steam for polyurethane Corrosive atmosphere : Stainless steel support possible

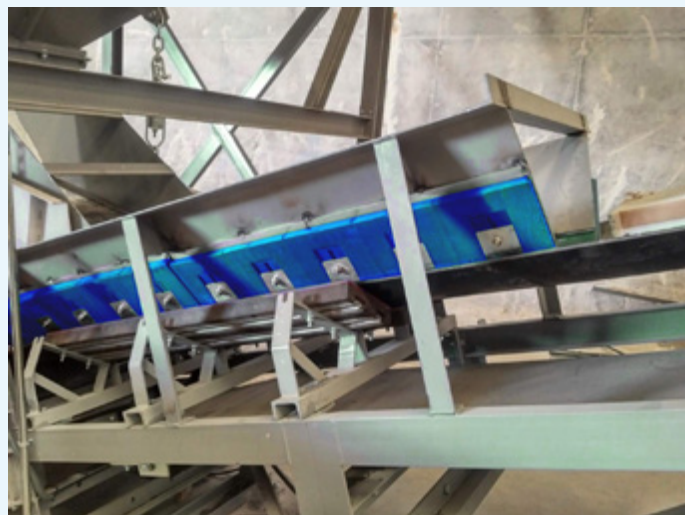



# SealBloc™

**MLT Conveyor Solutions Expert**  
More than 70 years of innovation  
at your service



[www.mltgroup-conveyor.com](http://www.mltgroup-conveyor.com) - [info@mltgroup-conveyor.com](mailto:info@mltgroup-conveyor.com)